

PORTAGE COUNTY BUSINESS PARK

Sales Status

- Sold
- Under Contract

Utilities

- Bicycle / Pedestrian Path
- Easement Boundary
- Overhead Transmission Lines



N

Feet

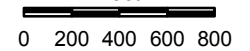

Planning and Zoning Department
1462 Strongs Avenue
Stevens Point, WI 54481
Production Date: July 29, 2010

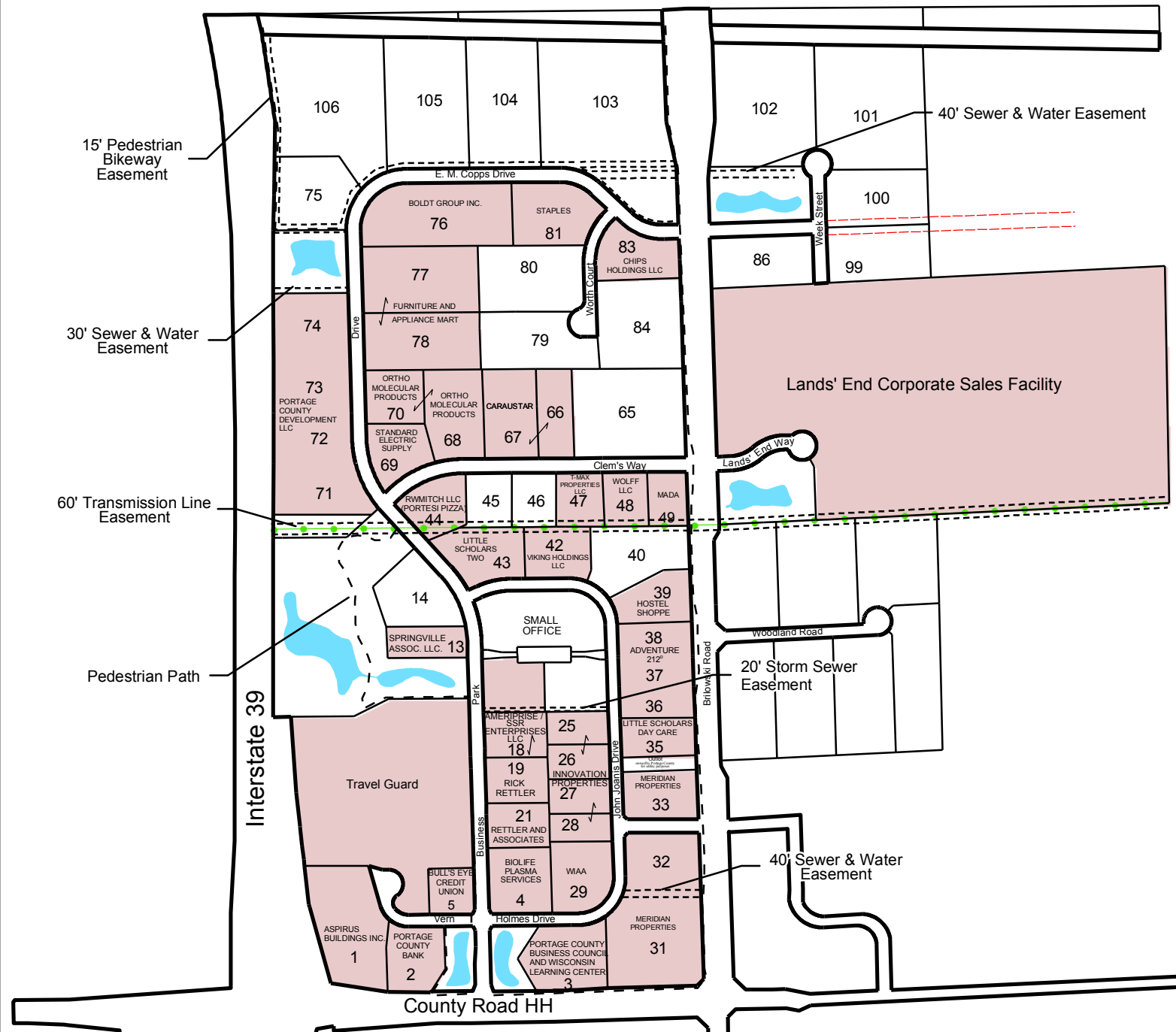

15' Pedestrian Bikeway Easement

30' Sewer & Water Easement

60' Transmission Line Easement

Pedestrian Path

Interstate 39

County Road HH

40' Sewer & Water Easement

Lands' End Corporate Sales Facility

20' Storm Sewer Easement

40' Sewer & Water Easement

Travel Guard

SMALL OFFICE

PORTAGE COUNTY BUSINESS COUNCIL AND WISCONSIN LEARNING CENTER

PORTAGE COUNTY BANK

SULL'S EYE CREDIT UNION

BIOLIFE PLASMA SERVICES

RICK RETTLER

AMERIPRISE / SSR ENTERPRISES LLC

WAA

INNOVATION PROPERTIES

LITTLE SCHOLARS DAY CARE

ADVENTURE 212

HOSTEL SHOPPE

VIKING HOLDINGS LLC

SCHOLARS TWO

ORTHOMOLECULAR PRODUCTS

FURNITURE AND APPLIANCE MART

STAPLES

BOLDT GROUP INC.

Lands' End

FWAX PROPERTIES LLC

CARAUSTAR

ORTHOMOLECULAR PRODUCTS

STAPLES

STAPLES

STAPLES

STAPLES

STAPLES

STAPLES

STAPLES

STAPLES